

ZANDPARK, LEIDSCHER RIJN, UTRECHT, THE NETHERLANDS Leidsche Rijn 区 Zandpark 公园

**Landscape Architects:** OKRA Landscape Architects bv  
**Location:** Utrecht, The Netherlands  
**Client:** Projectbureau Leidsche Rijn  
**Size:** 50,000 m<sup>2</sup>

**设计公司:** OKRA 景观设计师事务所  
**位置:** 荷兰乌特勒支  
**客户:** Projectbureau Leidsche Rijn  
**面积:** 50 000 m<sup>2</sup>

ARCHAEOLOGICAL POTENTIAL

The site, where the Zandpark will be, is a mysterious one. The location for the future park is nowadays an area that is inviting to be explored, spread with large farmers residences, narrow roads and canals. It's an intriguing contrast between open space, private arcadia and deserted greenhouse areas. And then there is the mystery of the archeological field. We know there once was a roman fortification, but today there is not any visible proof of that, all covered.

Normally a place like this would disappear under the pressure of a large scale building process that is going on around it, but because of its archeological potential the site it remains open. This slightly higher area will transform into a park for the residential area Leidsche Rijn, with clustered activities in strategic places.

具有考古价值

Zandpark 位于一片等待开发的神秘区域。这里到处是大型的农宅、狭窄的道路和长长的运河，与开放空间、世外桃源及荒芜的温室区相比，别有一番风味。这里曾经是一个罗马军事区，如今所有的历史都被掩埋，无法看到半点蛛丝马迹。正常来说，在周围大规模开发建设的压力下，像这样一块区域会很快消失掉。但是由于其潜在的考古价值，该区被保留了下来。这块率高于周围的基地将成为 Leidsche Rijn 居住区的公园，布置各种活动设施。

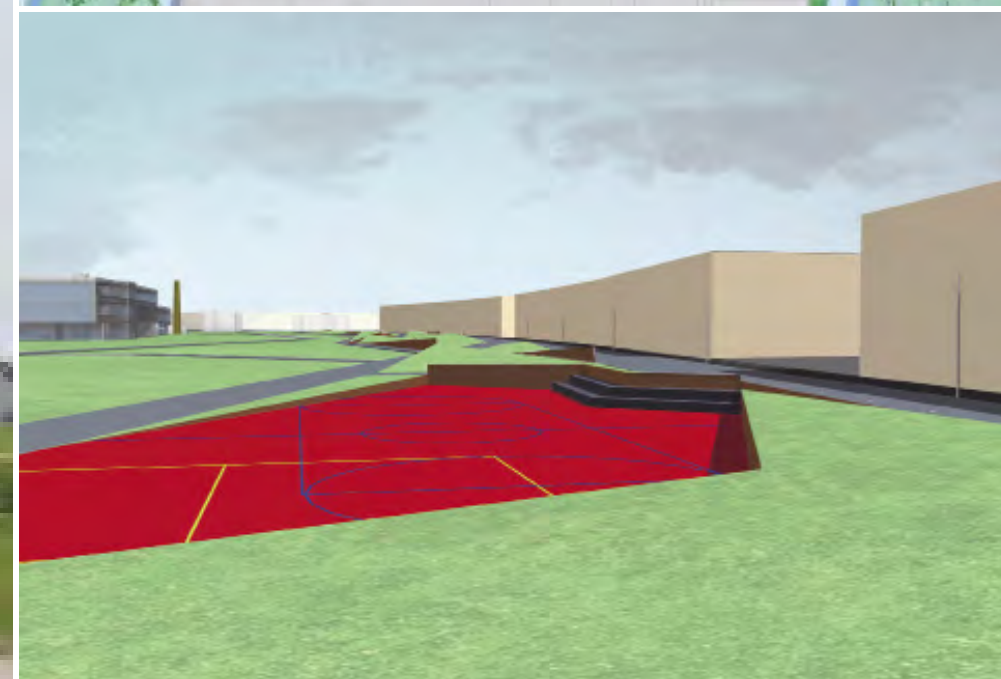
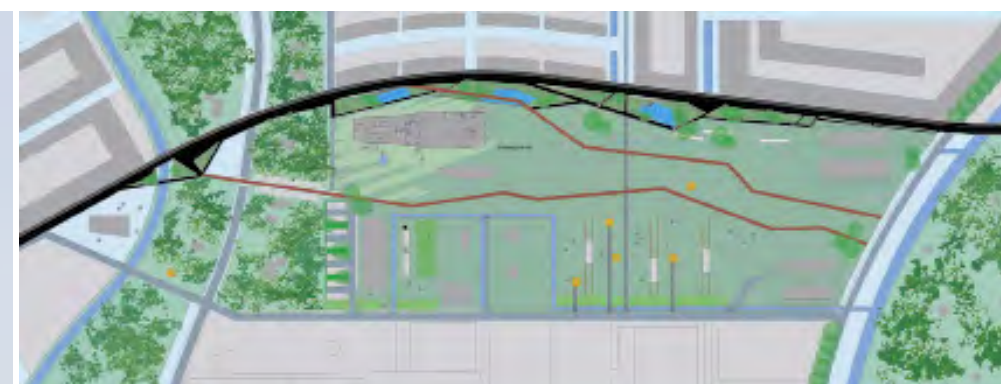

DESIGN CONCEPT

The design concept activates three time layers. The first one is the archeological field, where the mystery stays unrevealed and where just a few paths and some horses run through the uneven terrain. The fragility of the layer is expressed by the buildings that gently touch the surface, like space ships that just have landed.

The second layer is the one of the horticultural history, the greenhouses and the chimneys. This layer will be activated by relocating a few monumental greenhouses from nearby to the site and by giving them a 'horticultural' inspired program.

The third layer is the present one, linked to the cycle boulevard through Leidsche Rijn. This zone will be programmed with playgrounds. Cryptically drawn out fields challenge children to play their own game.

设计理念

该设计理念激活了该区的三层意义。第一层作为考古领域，它的神秘面纱尚未被揭去。唯有数条小道及马匹穿过凹凸不平的这片地带。这一层尤为脆弱，建筑轻轻地“靠在”地面上，如同宇宙飞船着陆般小心翼翼。

第二层是其作为荷兰园艺历史的一部分：花房和烟囱。附近几座意义非凡的花房将被迁移至此，其“园艺历史”将再次重现。

第三层，就是目前的这项工程。公园通过 Leidsche Rijn 区与环城路相连。这里将建有运动场，供儿童嬉戏玩耍。



